

香港丽晶酒店

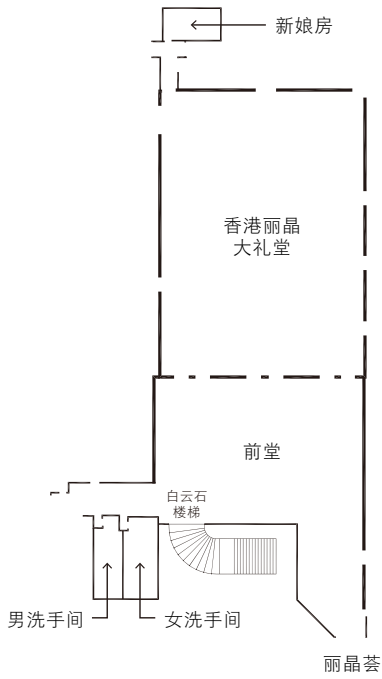

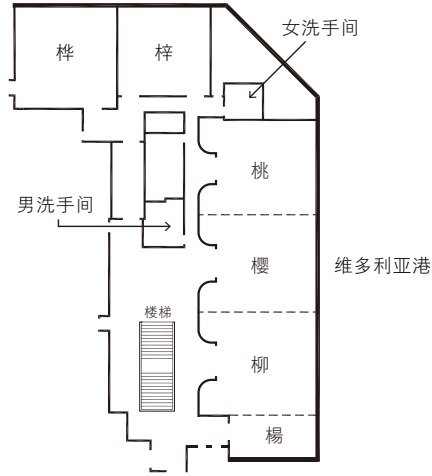



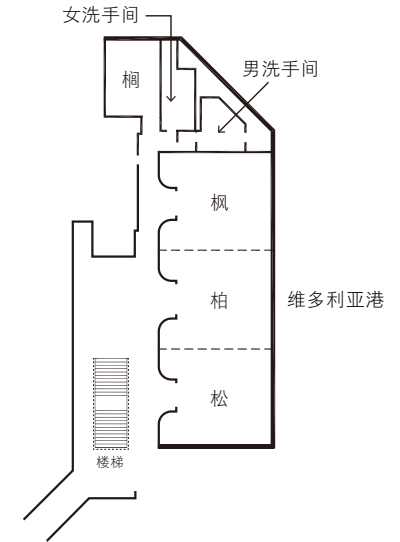

二楼



二楼



大堂

房间名称	 剧场	 课室	 鸡尾酒会	 宴会	 U形	 区域		 高度	
						平方米	平方呎	米	呎
松	70	48	70	48	24	75	807	2.3	7.6
柏	70	48	70	48	24	75	807	2.3	7.6
枫	70	48	70	48	24	75	807	2.3	7.6
桐	30	18	20	12	—	34	366	2.3	7.6
杨	—	—	20	24	—	33	355	2.3	7.6
柳	70	48	70	48	24	77	829	2.3	7.6
櫻	70	48	70	48	24	77	829	2.3	7.6
桃	70	48	70	48	24	77	829	2.3	7.6
梓	60	36	60	48	21	64	689	2.3	7.6
梓	70	48	70	48	24	79	850	2.6	8.6
松、柏、枫	210	120	200	168	72	225	2422	2.3	7.6
杨、柳、櫻、桃	240	140	220	216	72	264	2842	2.3	7.6
香港丽晶大礼堂	1000	480	1000	720	120	839	9031	4.5	15
前堂	—	—	400	168	—	411	4424	2.6	8.6